

**TOP VIEW**

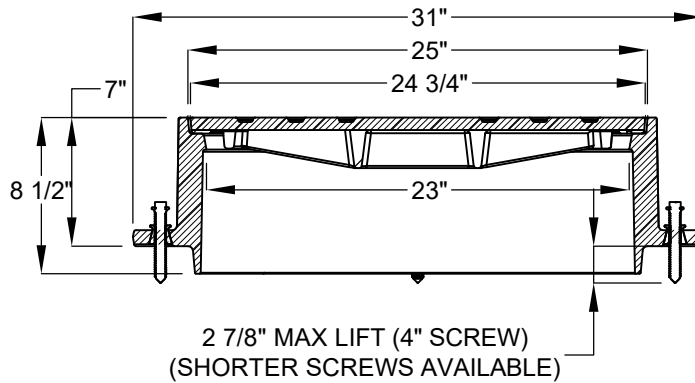

**SECTION A-A**

Notes:

1. CASTING ASSEMBLY TO BE H20 LOAD RATING OR AS APPROVED BY CITY ENGINEER
2. SCREWS SHALL BE ZINC-PLATED, MILD STEEL CONFORMING TO ASTM A 1018.
3. NUTS SHALL BE ZINC ALLOY CONFORMING TO ASTM C41A.
4. GAPS SHALL BE FILLED WITH NON-SHRINK GROUT PER THE MOST CURRENT WSDOT STD. SPECIFICATIONS 9-20.3(2).
5. MANHOLE RING SHALL BE SHIMLESS ADJUST-TO-GROUND FOLLOWING MANUFACTURER'S REQUIREMENTS. ADJUST SCREWS TO MEET FINISHED GRADE.
6. SEE LONGVIEW STD. PLAN SD-170 FOR MANHOLE COVERS.



**23" x 8 1/2" MANHOLE FRAME**

STANDARD PLAN:  
**SD - 150**

PUBLIC WORKS DIRECTOR APPROVAL  
Longview: **K.H.**

DATE: **FEB 2021**

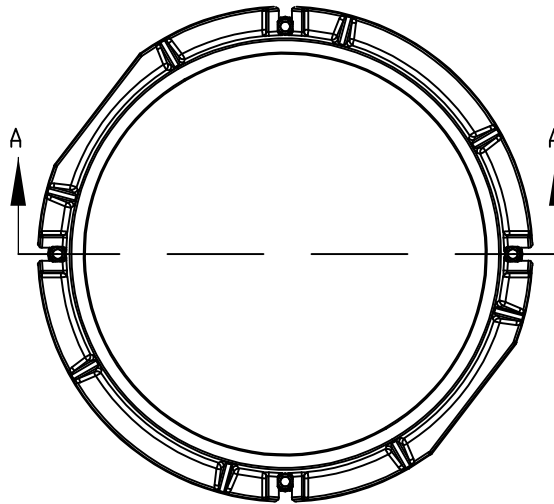

**TOP VIEW**

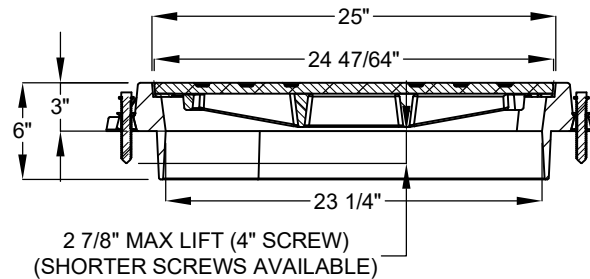

**SECTION A-A**

Notes:

1. CASTING ASSEMBLY TO BE H20 LOAD RATING OR AS APPROVED BY CITY ENGINEER
2. SCREWS SHALL BE ZINC-PLATED, MILD STEEL CONFORMING TO ASTM A 1018.
3. NUTS SHALL BE ZINC ALLOY CONFORMING TO ASTM C41A.
4. GAPS SHALL BE FILLED WITH NON-SHRINK GROUT PER THE MOST CURRENT WSDOT STD. SPECIFICATIONS 9-20.3(2).
5. MANHOLE RING SHALL BE SHIMLESS ADJUST-TO-GROUND FOLLOWING MANUFACTURER'S REQUIREMENTS. ADJUST SCREWS TO MEET FINISHED GRADE.
6. SEE LONGVIEW STD. PLAN SD-170 FOR MANHOLE COVERS.
7. USE OF THIS FRAME ONLY PERMISSIBLE WITH CITY ENGINEERS APPROVAL. SD-150 TO BE USED FOR NORMAL CIRCUMSTANCES.



**23" x 6" MANHOLE FRAME**

STANDARD PLAN:  
**SD - 160**

PUBLIC WORKS DIRECTOR APPROVAL  
Longview: **K.H.**

DATE: **FEB 2021**

7" ADJUSTABLE RING

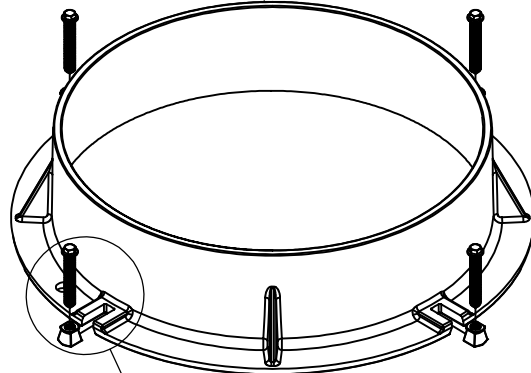
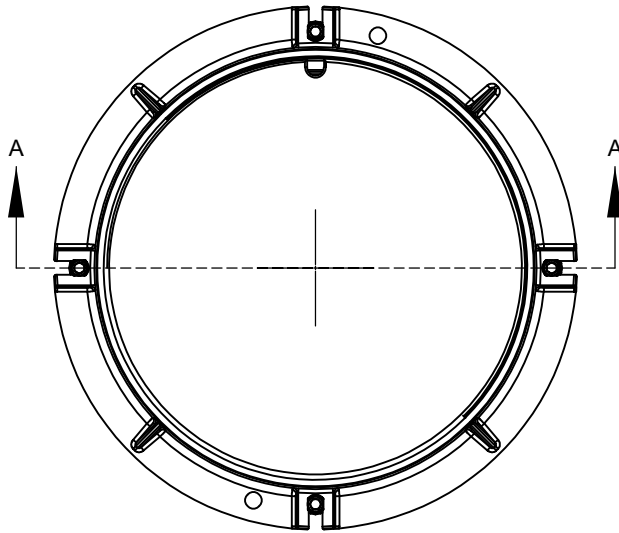

**DETAIL A**

(4) 5/8" BY 4" JACK SCREW WITH 5/8" HEX HEAD

**TOP VIEW**

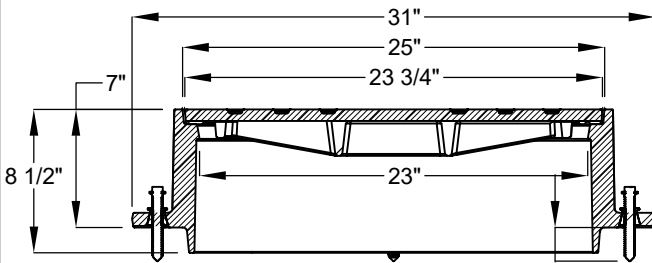

2 7/8" MAX LIFT (4" SCREW)  
(SHORTER SCREWS AVAILABLE)

**SECTION A-A**

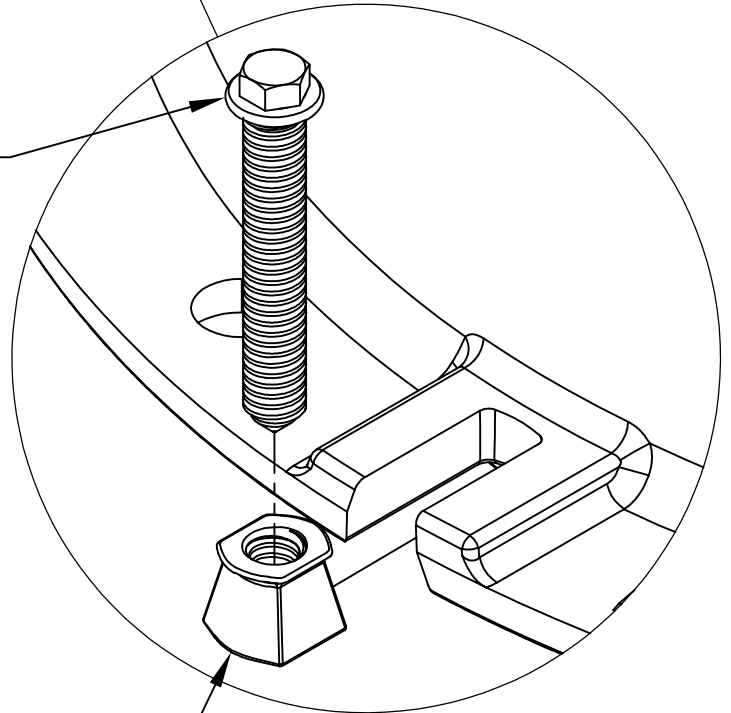

(4) 5/8" SLOT NUT INSERT

**NOTES:**

1. CASTING ASSEMBLY TO BE H20 LOAD RATING OR AS APPROVED BY CITY ENGINEER.
2. SCREWS SHALL BE ZINC-PLATED, MILD STEEL CONFORMING TO ASTM A 1018.
3. NUTS SHALL BE ZINC ALLOY CONFORMING TO ASTM C41A.
4. GAPS SHALL BE FILLED WITH NON-SHRINK GROUT PER THE MOST CURRENT WSDOT STD. SPECIFICATION 9-20.3(2).
5. MANHOLE RING SHALL BE SHIMLESS ADJUST-TO-GRADE FOLLOWING MANUFACTURER'S REQUIREMENTS. ADJUST SCREWS TO MEET FINISHED GRADE.
6. SEE LONGVIEW STD. PLAN SS-120 FOR MANHOLE COVERS.



**23" x 8 1/2" MANHOLE FRAME**

STANDARD PLAN:  
**SS - 100**

PUBLIC WORKS DIRECTOR APPROVAL:  
Longview: **K. H.**

DATE: **FEB 2021**

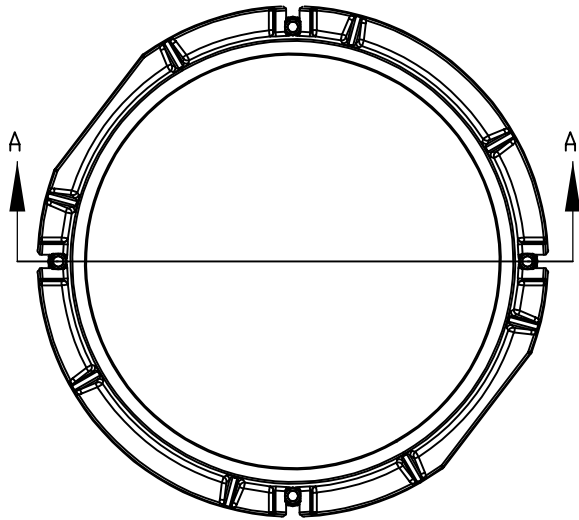

**TOP VIEW**

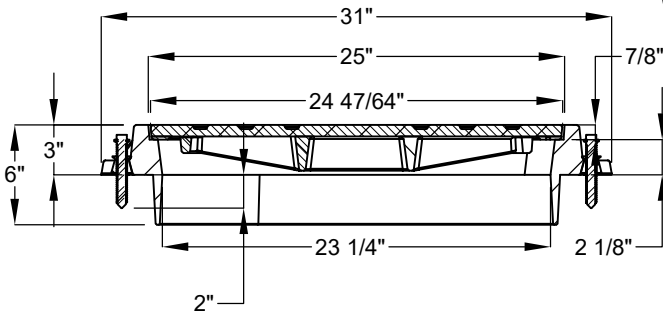

**SECTION A-A**

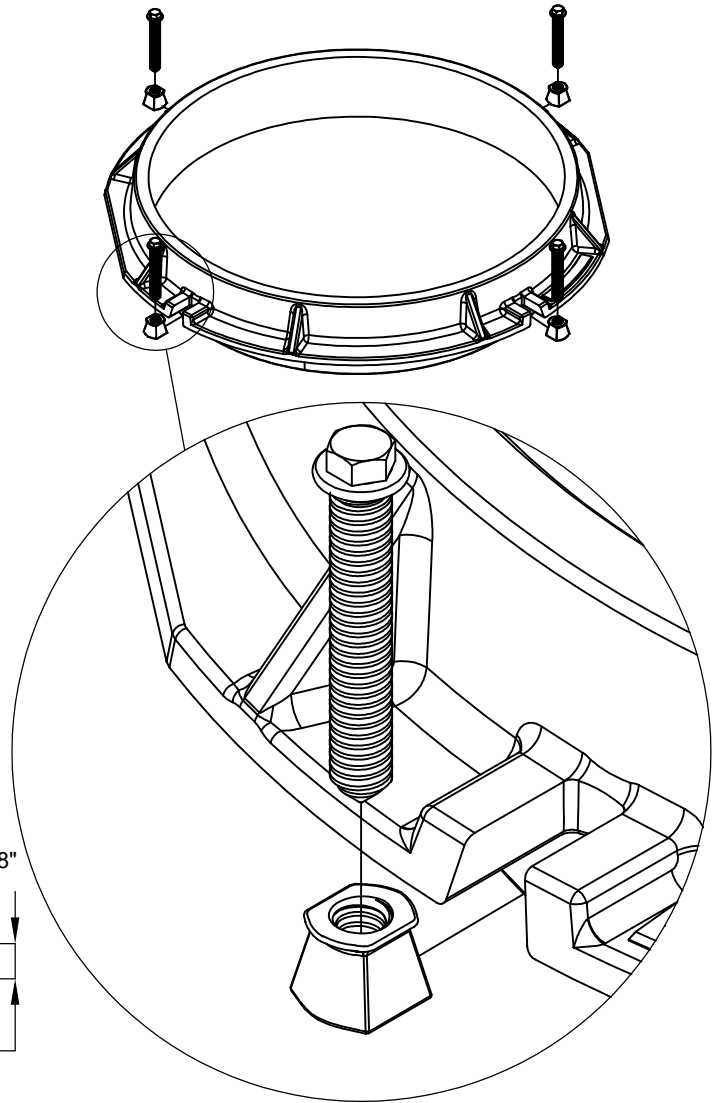

Notes:

1. CASTING ASSEMBLY TO BE H20 LOAD RATING OR AS APPROVED BY CITY ENGINEER
2. SCREWS SHALL BE ZINC-PLATED, MILD STEEL CONFORMING TO ASTM A 1018.
3. NUTS SHALL BE ZINC ALLOY CONFORMING TO ASTM C41A.
4. GAPS SHALL BE FILLED WITH NON-SHRINK GROUT PER THE MOST CURRENT WSDOT STD. SPECIFICATIONS 9-20.3(2).
5. MANHOLE RING SHALL BE SHIMLESS ADJUST-TO-GROUND FOLLOWING MANUFACTURER'S REQUIREMENTS. ADJUST SCREWS TO MEET FINISHED GRADE.
6. SEE LONGVIEW STD. PLAN SS-120 FOR MANHOLE COVERS.
7. USE OF THIS SIZE FRAME ONLY PERMISSIBLE WITH CITY ENGINEERS APPROVAL. SS-100 TO BE USED FOR NORMAL CIRCUMSTANCES.



**23" x 6" MANHOLE FRAME**

STANDARD PLAN:  
**SS - 110**

PUBLIC WORKS DIRECTOR APPROVAL:  
Longview: **K.H.**

DATE: **FEB 2021**